



ASSEMBLY INSTRUCTIONS

UXL Nest and Fold Table



SPECIAL NOTES

1. Check that all components are accounted for and undamaged before assembling.
2. Please assemble product in a clean dry area.
3. For larger units, you may need another person to help assemble the product.
4. Clean the product with a mild cleaner and a damp cloth.



For assistance in assembling product, missing or damaged parts, or to place an order, please contact customer service at 800-328-1061.

You may also place your order online at

COMPONENTS & HARDWARE

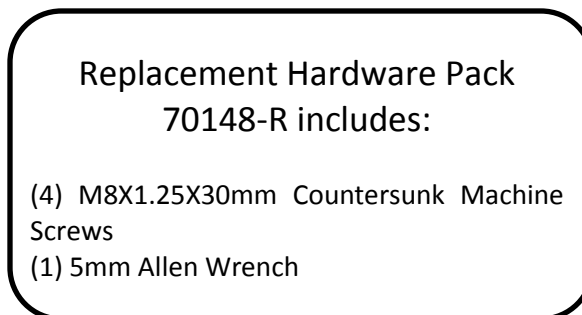
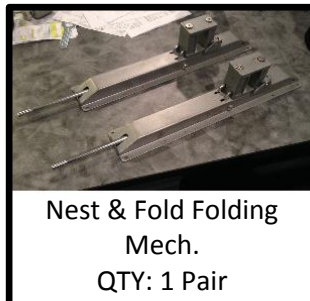

For assistance in assembling product, missing or damaged parts, or to place an order, please contact customer service at 800-328-1061. You may also place your order online at

ASSEMBLY INSTRUCTIONS

Step 1: Lay the frame with the attached top upside down on a clean dry surface.

Step 2: Pull the handle towards the front of the table to unlock the mechanisms and flip both mechanisms up.

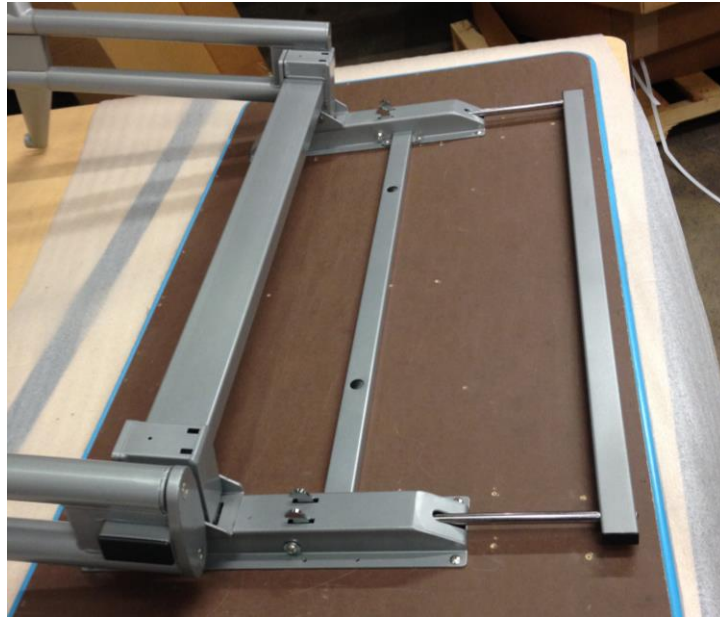

Step 3: Remove the top plate from both legs.

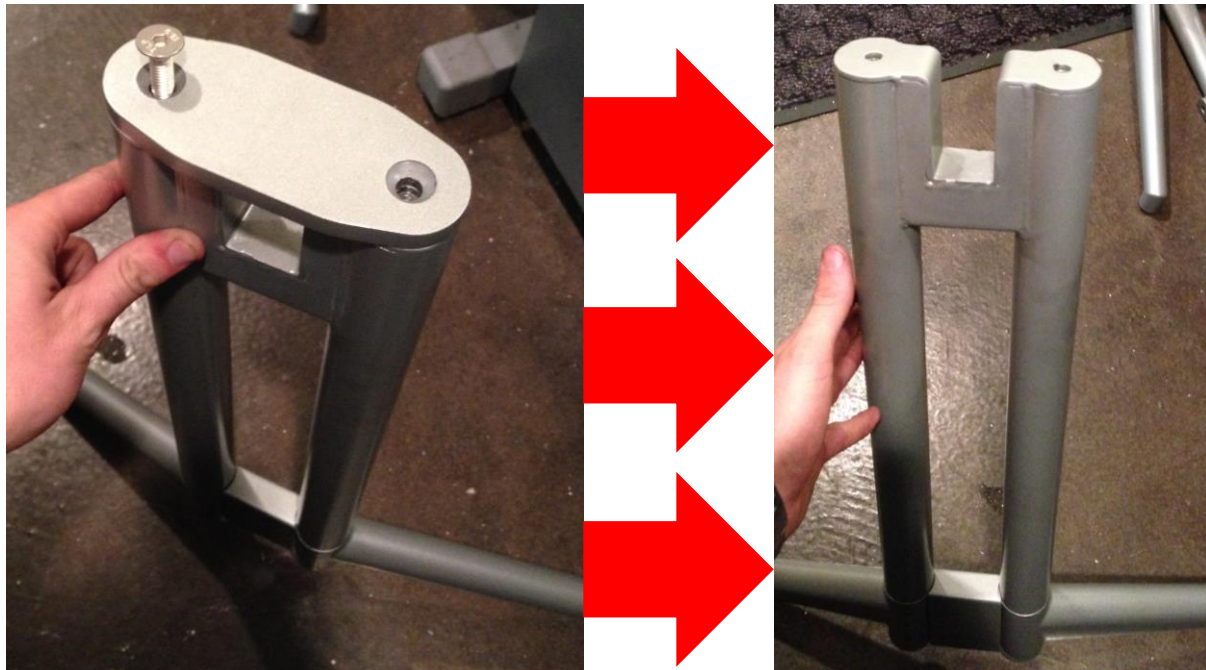

For assistance in assembling product, missing or damaged parts, or to place an order, please contact customer service at 800-328-1061.

You may also place your order online at

Step 4: Slide the leg around the beam ensuring that the longer leg faces towards the handle and the shorter leg faces away from the handle. (FACE LEG'S FEET OUTWARDS)

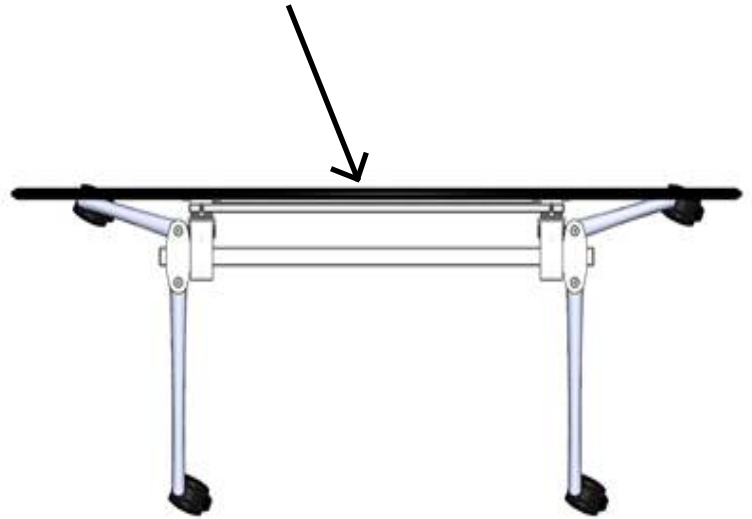

Step 5: Attach both legs to each side of the beam and tighten using a 5mm Allen Wrench, bolts, and plate removed in Step 2.



Step 6 (Optional): Lock the legs back into their upright positions. Attach casters to the bottom of the leg sets using the supplied wrench to tighten fully.

For assistance in assembling product, missing or damaged parts, or to place an order, please contact customer service at 800-328-1061.

You may also place your order online at

Step 7: Ensure legs are locked into position and place table into upright position.



Step 8: To level table, adjust caster up or down by turning the hex nut below silver knurled disc - clockwise or counter-clockwise until level. Lock in place by turning.

For assistance in assembling product, missing or damaged parts, or to place an order, please contact customer service at 800-328-1061. You may also place your order online at