



# in2it™ mobile stack chair

18" seat height, a-shell

MODEL #: 00507

IN2IT MOBILE CHAIR (A SHELL) 18"H

**DIMENSIONS + FREIGHT** *\*product is UPSable.*

MODEL #	D"	W"	H"	F.C.	CUBE	WEIGHT
00507	19.9"	18.9"	18"	125	4	15 lbs.

**OVERVIEW**

The In2it is our most ergonomic option with unmatched comfort and style. The shell is contoured for comfort in the seat and the back. The first cooperative learning chair. It's shape was derived purely as an invitation to come, sit and learn. Meanwhile, it's ample dimensions make students of all sizes comfortable throughout the day. The In2it chair is the latest expression of furniture that contributes to a healthy, effective learning environment.

**MATERIALS**

The SHELL is 100% virgin polypropylene material with color throughout and a distinct texture to prevent slipping. The free flowing design of the In2it comes from the innovative use of Gas Injection Technology. The integrated handle eases classroom positioning.

The FRAME is constructed from 16-gauge 1 1/8" diameter steel tube, protected by a durable powder coat finish and is MIG welded for maximum strength. The tubular frame supports the perimeter of the shell and incorporates a reinforcing crossbar for added strength. The shell is anchored securely to the frame through six 11-gauge die formed brackets, no rivets.

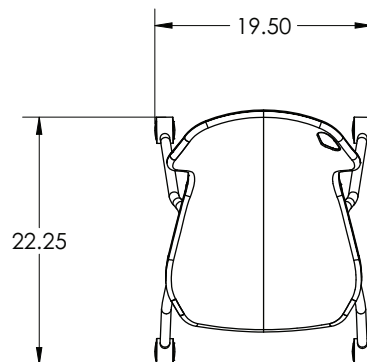
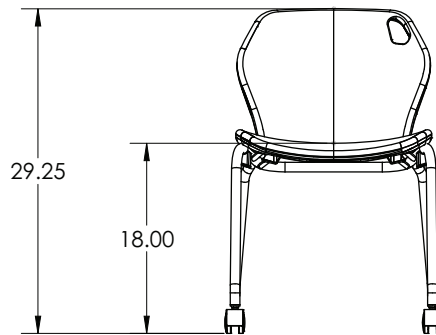

## In2it™ Frame Color Options



PLATINUM  
PLT

## In2it™ Shell Color Options



APPLE A



BLACK B



BLUEBERRY C



BURGUNDY D



CERULEAN S



CHARCOAL R



CHOCOLATE Q



CLEMENTINE E



FOREST GREEN F



FUCHSIA G



MINT H



MOCHA T



NAVY I



PERSIAN BLUE J



PURPLE K



RED L



YELLOW N