

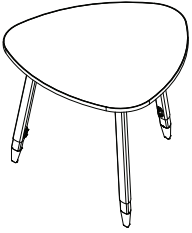

Flowform[®]

round triangle table

MODEL #: 56001E + 56002E



#56001E - GLIDES
(nylon or felt tips)

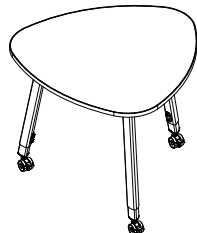

#56002E - CASTERS
2" lockable casters

OVERVIEW

The Orbit[®] Round Triangle table features rounded corners in a triangle shape. Pair with our Flowform[®] Soft Seating and Storage to create individual zones for student engagement and learning.

MATERIALS

The 3/4" thick WORK SURFACE consists of a 45 lb density particle board core with a .030" high pressure laminated surface and a .020" melamine backer sheet. The edge of the work surface features an ABS plastic 3mm flat self edge which matches the work surface laminate. Rounded edges blend and form into our Flowform[®] storage units for a cohesive space.

The legs are bolted to the underside of the tabletop as well as the secondary surface for added structural rigidity. Legs are angled triangle tubing that adjust from 26" - 40" height in 1" increments.

WEIGHT CAPACITY: 400 lbs

LAMINATE & MATCHING 3MM EDGE



FRENCH PEAR
FPR



MISSION MAPLE
MIM



NORTH SEA GRAY
NOS



3/4" top with 3mm flat edge.
E to follow Model No.

FRAME COLOR:



SILVER
SLV

DIMENSIONS + FREIGHT

Model	Description	D"	W"	H"	F.C.	Cube	WT
56001E	w/ glides	31.5	32	26-40			47
	shipping dimensions	40	48	18	70	17	91
56002E	w/ casters	31.5	32	26-40			47
	shipping dimensions	40	48	18	70	17	93

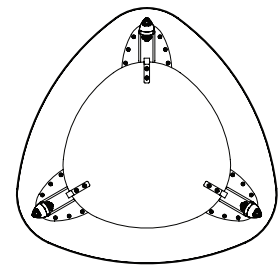
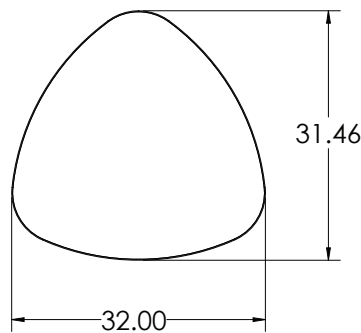

BOTTOM VIEW

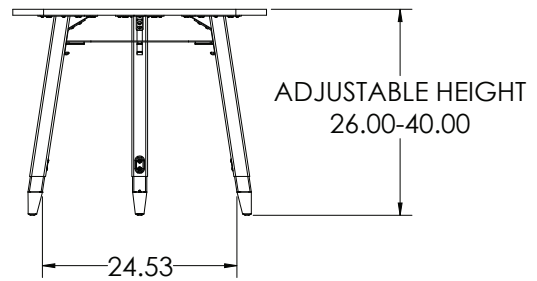

ADJUSTABLE HEIGHT
26.00-40.00

