



Elemental® Horseshoe Activity Table

MODEL #: ELHOSH_____



OVERVIEW

Elemental® tables have optional colored casters and matching colored leg sets. The unique colored legs comes in four configurations: fixed height (EG), adjustable height (EA), fixed height for use with casters (EC), or low range adjustable (EL).

MATERIALS

The 1 1/4" thick WORK SURFACE consists of a 45 lb density particle board core with a 0.030" high pressure laminated surface and a 0.020" melamine backer sheet. The edge of the tabletop features your choice of a 3/8" bumper t-mold or 4mm t-mold, which is then fastened to the underside of the work surface every 6 to 8 inches to assure a long lasting fit. Mounted under the work surface is a 14 gauge steel STIFFENER for reinforcement.

LEG STYLE 14 15

1. "EG" - Fixed-Height 30"
2. "EC" - Fixed-Height 27" (use w/ 3" casters = 30"H)
3. "EA" - Adjustable Height 19" - 33" (with glides)
4. "EL" - Low Range Adjustable 11"-17" (with glides)

The Elemental® LEG SETS are constructed of 14-gauge steel with a durable powdercoat paint finish in one of five colors. The legs are reinforced by a gusseted, 'spade' shaped, mounting plate. Each one of the 6 legs attach to the pre-drilled holes in the top with 10 #10 x 5/8" screws per leg. Legs come standard with a nylon base glide.

ADD COLORED CASTERS Model 17599 ___ (6-pack)



* REMINDER: Casters sold separately! (17599 ___ [6-pack])

OPTIONAL dual-wheel 3" casters available, ordered separately as their own line item.

BUILD PART NUMBER

EL or E8	H O S H	7 8 9 10	11 12 13	14 15
	Choose MODEL	Pick Laminate Color	Pick Edge Color	Pick Leg Color
				Pick Leg Style <small>(ES) 22.5" - 29.5" Adjustable Leg - Student Desks.</small>

DIMENSIONS

Model	Description	Leg Type	D"	W"	H"	F.C.	WT
ELHOSH_____EG	Horseshoe Table	Fixed Height	66	57	30	70	156
ELHOSH_____EC*	Horseshoe Table	Fixed Height for Caster	66	57	27**	70	156
ELHOSH_____EA	Horseshoe Table	Adjustable Ht (19-33")	66	57	19-33	70	156
ELHOSH_____EL	Horseshoe Table	Adjustable Ht (11-17")	66	57	11-17	70	156

* REMINDER: Casters sold separately!

**3" Casters make table height 30."

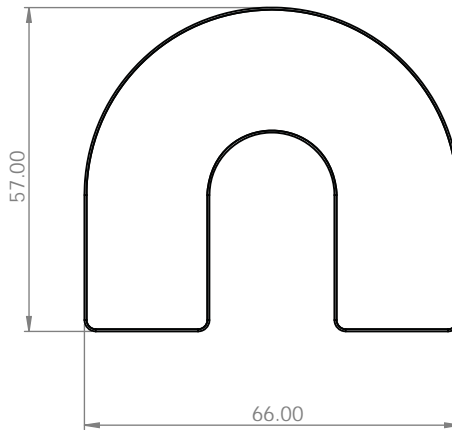

Drawings shown with 'EC' style legs, with optional 3".
**3" Casters make table height 30."
* REMINDER:
Casters sold separately! (17599 ___)

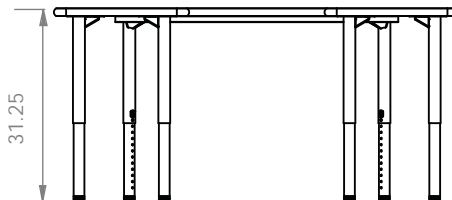

Elemental® Tables have optional colored casters and matching colored legsets.

STANDARD LAMINATE OPTIONS

Want to specify a different laminate?

No problem. If you have 20 or more tops of the same color -60 or -38 there is no upcharge. Have 20 or less? We can quote for you with the Wilsonart code and – finish style. We can specify other laminates–call to inquire and get a quote.

SUGGESTED STANDARD LAMINATES: 7 8 9

 ASIAN NIGHT 7949-60 ANG	 BOARDWALK OAK 7983-60 BWK	 PEWTER MESH 4878-60 PEW	 CLASSIC LINEN 4943-60 CLN	 HIGH RISE 4996-60 HRE	 NEW AGE OAK 7938-60 NEW	 NORTH SEA GRAY D90-60 NOS
 BUKA BARK 7982-60 BBK	 PALISADES OAK 7987-60 PSO	 FLAX LINEN 4990-60 FLL	 MISSION MAPLE 7990-60 MIM	<p>All 15 of the standard laminates are -60 finish, if you need to match a laminate from a previous year, please let us know on your order (example Pewter Mesh 4878-38, our standard is -60).</p> <p>When the WilsonArt Laminate code includes a "Y", "K", "-12", "-78", "Aeon" etc, these are special laminates with an upcharge, even when it contains -38 or -60.</p>		
Classic Standard Laminates:						
 FRENCH PEAR 8220-60 FRP	 WILD CHERRY 7054-60 CHE	 GREY NEBULA 4622-60 GNB	 FUSION MAPLE 7909-60 MAP			

BUILD PART NUMBER

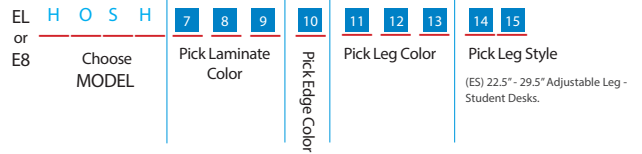

STANDARD EDGE COLOR OPTIONS: 10

 APPLE A	 BLACK B	 BLUEBERRY C	 BURGUNDY D	 CERULEAN S	 CHAMPAGNE O	 RED L
 CHARCOAL R	 CHOCOLATE Q	 CLEMENTINE E	 FOREST GREEN F	 FUCHSIA G	 MINT H	 YELLOW N
 MOCHA T	 NAVY I	 ORANGE U	 PERSIAN BLUE J	 PLATINUM P	 PURPLE K	

ELEMENTAL® LEG COLORS 11 12 13

 PLATINUM PLT	 CHARCOAL CGR	 ORANGE ORG
 APPLE APL	 CERULEAN CER	

ELEMENTAL® LEG STYLE 14 15



LEG STYLE:

- "EG" - Fixed-Height 30"
- "EC" - Fixed-Height 27"
(use w/ 3" casters = 30"H).
- "EA" - Adjustable Height
(19" - 33" w/ glides)
(21.5" - 35.5" w/ 3" casters)
- "EL" - Low Range Adjustable
(11" - 17" w/ glides)
(13.5" - 19.5" w/ 3" casters)

**3" Casters make table height 30."

* REMINDER:
Casters sold separately!