



Elemental® Bookbox

Steel Bookbox

MODEL#: 17191



Model ELPETL. Shown with optional Steel Bookbox

OVERVIEW

The Smith System® solid steel bookbox is an easy way to add storage space for books, supplies, even laptops, to many student desks. The bookbox is available in a durable black or platinum powder coat paint finish.

MATERIALS

All welded 18-gauge steel construction provides sturdy support for books and supplies under the work surface. The solid steel box attaches with 6 screws on the underside of applicable Smith System® student desks.

BOOKBOX COMPATABILITY

| ELEMENTAL® SERIES | MODEL |
|-------------------------------|--------|
| Elemental® Huddle Desk | ELHUDL |
| Elemental® Triangle Desk | ELTRGL |
| Elemental® Wing Desk | ELWING |
| Elemental® Student Petal Desk | ELPETL |

FRAME COLOR



PLATINUM

DIMENSIONS

| Model | Description | D" | W" | H" | F.C. | Cube | WT |
|-------|--------------------------|-------|-------|------|------|------|----|
| 17191 | Elemental® Steel Bookbox | 14.77 | 17 | 4.38 | 70 | .5 | 6 |
| | shipping dimensions | 20.5 | 27.75 | 7 | | | 8 |

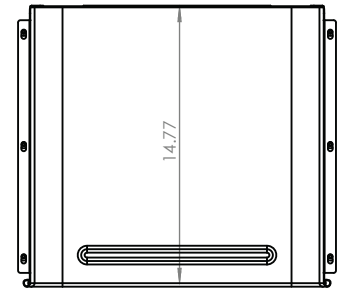
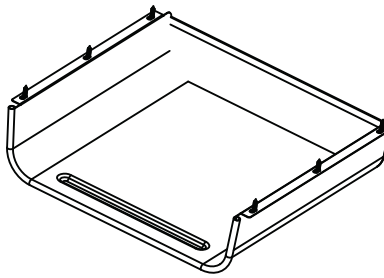

Top View

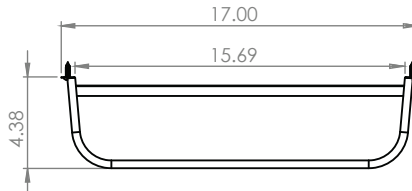

Front View

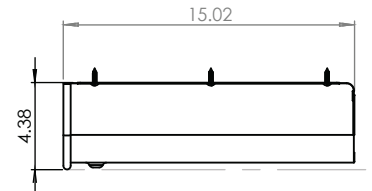

Side View