

Assembly Instructions

MOTUM TEACHERS DESK FIXED HEIGHT LEFT HAND

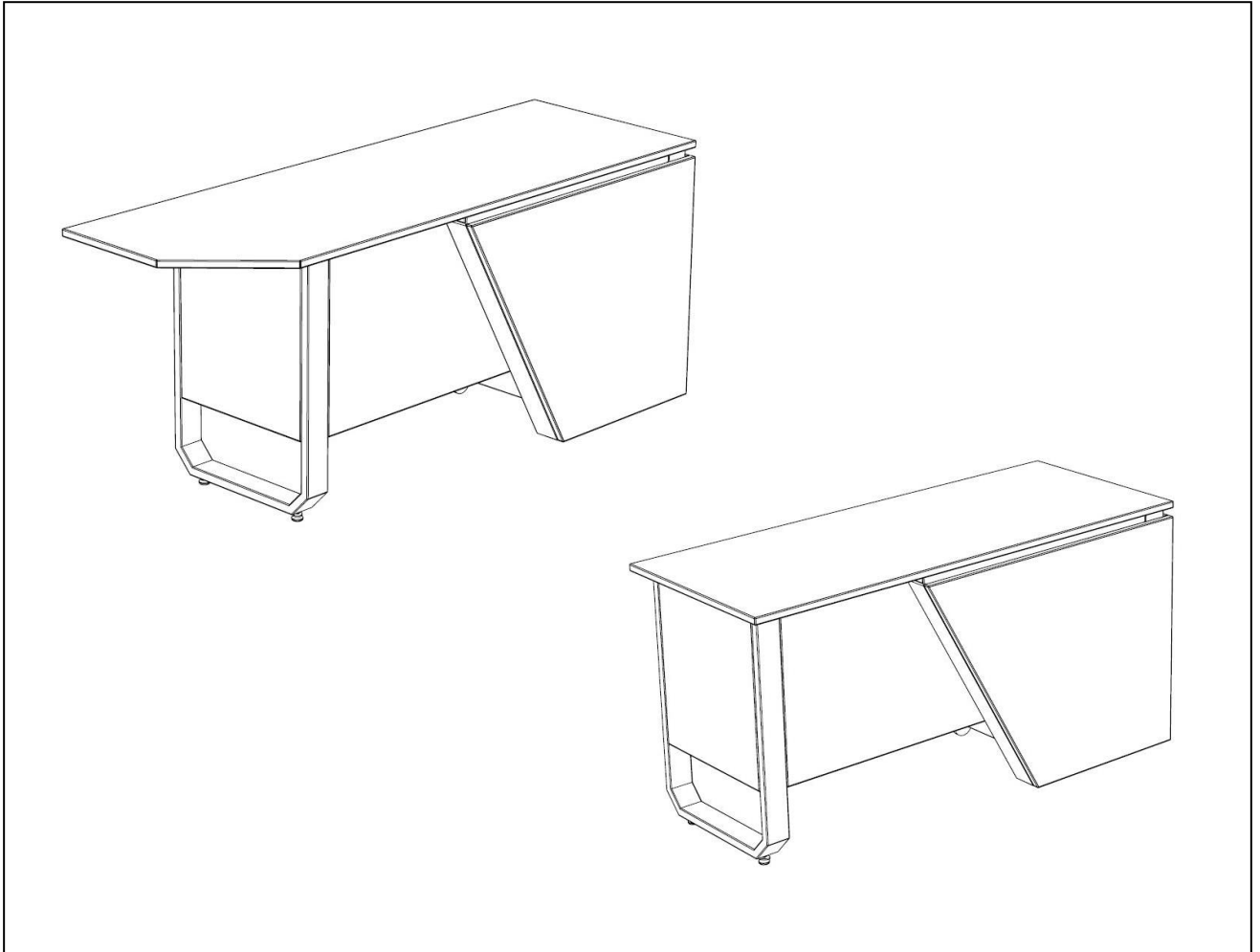

MODEL NUMBERS

58001, 58003, 58005, AND 58007

If you have damaged or missing components,
please contact customer service at 1-800-328-1061

Hardware and Components

ITEM NO.	PartNo	REV	DESCRIPTION	DRAWING/QTY.
1	P14260	B	TEACHERS DESK U TUBE LEG ASSEMBLY	1
2	P10525		SWIVEL GLIDE W/ GLIDE STOP	2
3	P14265	C	TEACHERS DESK STRAIGHT TUBE LEG ASSEMBLY	1
4	P14271	B	TD BRACED L BRACKET	1
5	P14272	A	TD STRAIGHT TUBE LEG Z BRACKET	1
6	P14273	B	TD BOLT ON L BRACKET	1
7	P14274	A	TD SIDE PANEL CLIP	2
8	P14275	A	TD U TUBE LEG Z BRACKET	1
9	P14276	A	TD L BRACKET FRONT 120	1
10	P14277	A	TD FILLER BRACKET	2
11	P14278	A	TD L BRACKET FRONT MAIN	1
12	P14279	A	TD FRONT MAIN TO 120 SPACER	1
13	60139	B	TEACHERS DESK HARDWARE PACK	1
14	P14503	A	TD FIXED HEIGHT SHIM	4

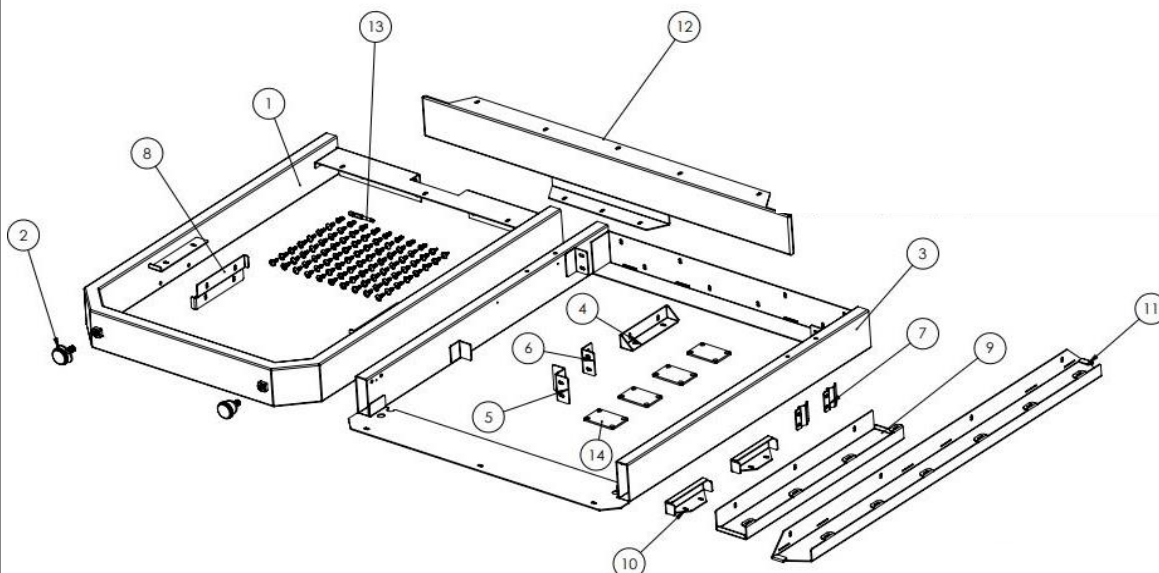

For 72" Models Only (58005 and 58007)

ITEM NO.	PartNo	REV	DESCRIPTION	DRAWING/QTY.
15	P14297	A	TEACHERS DESK TD SUPPORT BRACE	1
16	60141	A	TEACHERS DESK SUPPORT BRACE HARDWARE PACK	1

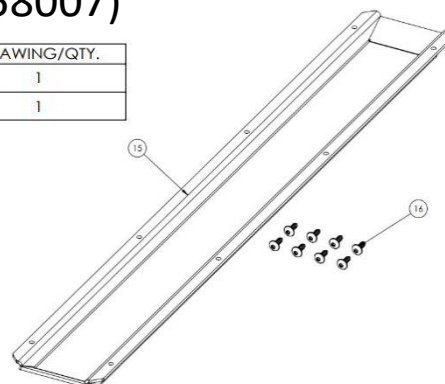

Hardware and Components

ITEM #13 – TEACHERS DESK HARDARE PACK COMPONENTS

ITEM NO.	PartNo	DESCRIPTION	DRAWING/ QTY.
1	P14322	NO. 10 X 5/8" TORX BUTTON HEAD SCREW	70
2	P14324	NO. 10 X 1/2" TORX SELF DRILLING BUTTON HEAD SCREW	2
3	P14323	10-32 X 1/2" TORX BUTTON HEAD W/ PATCH	8
4	P14329	T25 TORX POWER BIT 2"	1

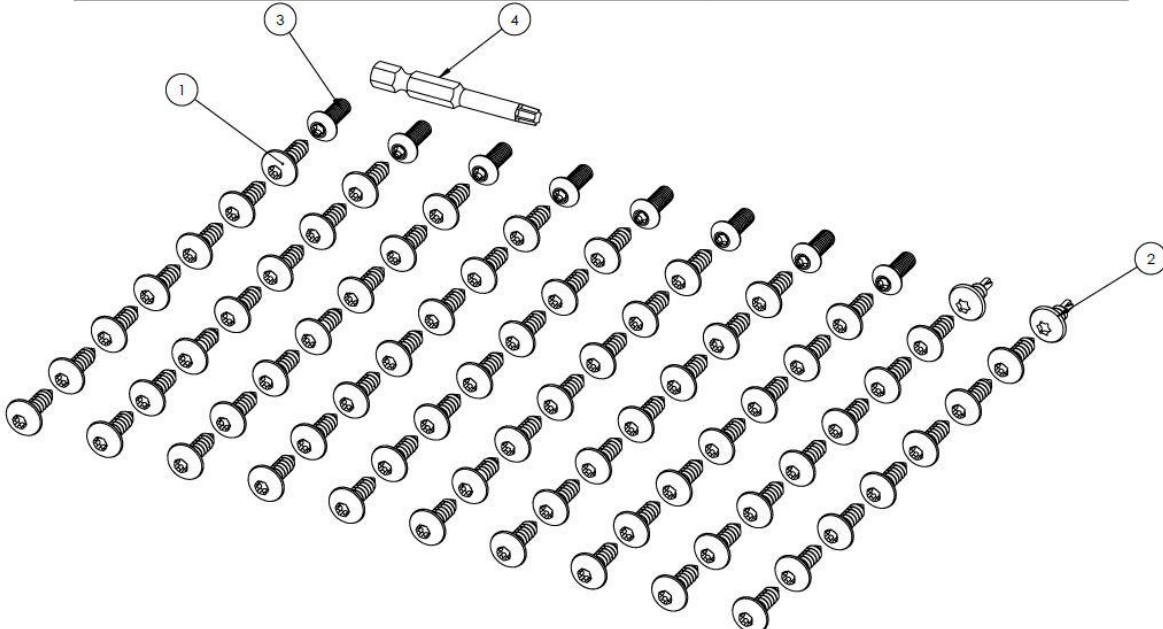

USED ON
58003 and 58007

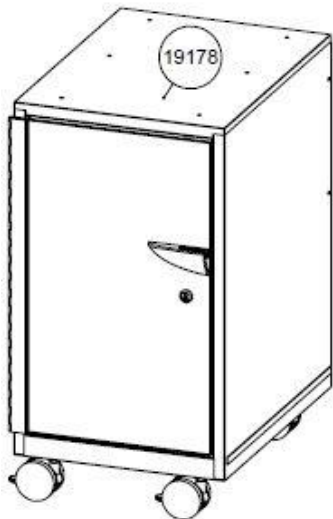

USED ON
58001 and 58005

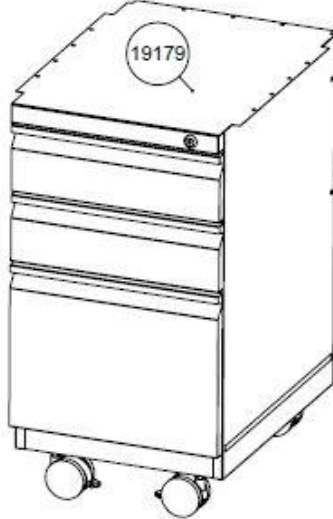

Hardware and Components

PANEL LETTER	PART NUMBER	DESCRIPTION	QTY.
A	P14400	TD STRAIGHT LEG SIDE PANEL	1
B	P14399	TD U LEG SIDE PANEL	1
D	P14403	TD MAIN FRONT PANEL LH	1
C	P14401	TD 120 FRONT PANEL LH	1

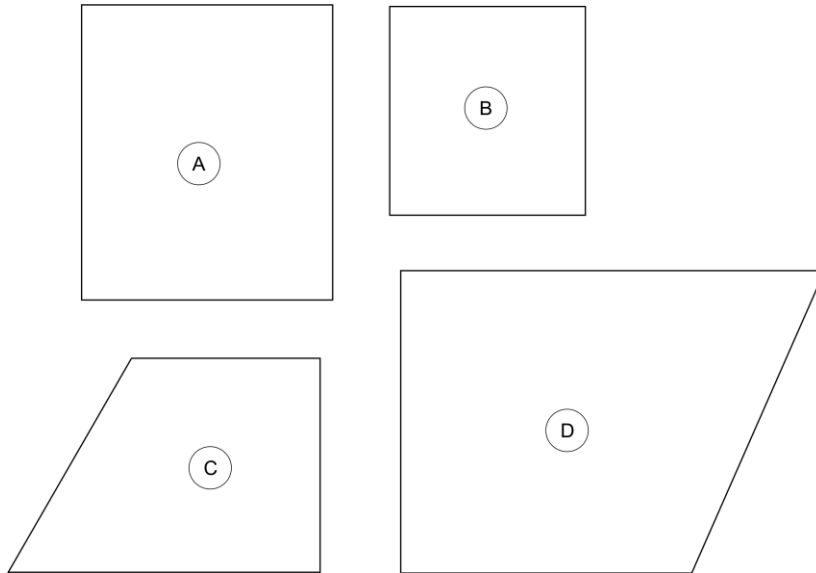

PANEL LETTER	PART NUMBER	DESCRIPTION	QTY.
E	P14390	TD 24X60" TOP LH	1

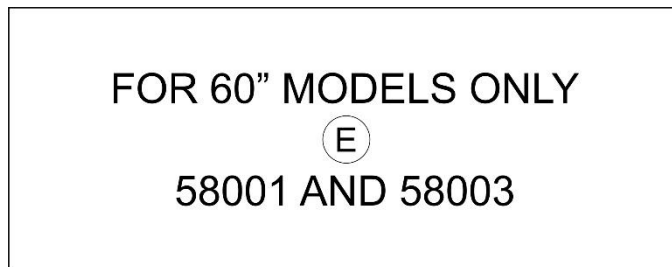

PANEL LETTER	PART NUMBER	DESCRIPTION	QTY.
H	P14392	TD 24X72" TOP LH	1

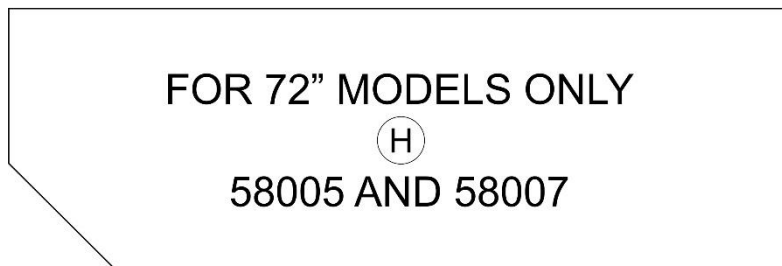

Special Notes:

- TOOLS REQUIRED:
 - Framing square.
- OPTIONAL TOOLS:
 - Wood Clamps, ¼" bit extender
- Check that all components are accounted for and undamaged before assembling.
- Please assemble the product in a clean and dry area.
- Clean the product with a mild cleaner and a damp cloth.
- It is highly recommended to assemble this with 2 people.

Assembly Instructions

1. Place wood top on clean smooth surface upside down with the pilot holes facing up, fasten 2x item #7 to item A using 4x fasteners item #1 using the supplied T25 Torx bit item # 4.

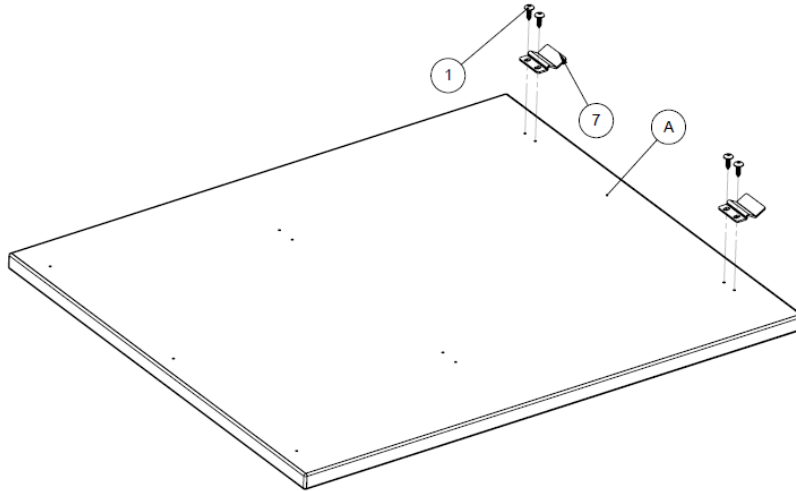

2. Position Panel B as shown, centering the panel to create equal gaps, a spacer or credit card works well. Fasten panel #7 to item A using 4x fasteners item #1 using the supplied T25 Torx bit item # 4. NOTE: The panel should sit on the metal finger as shown.

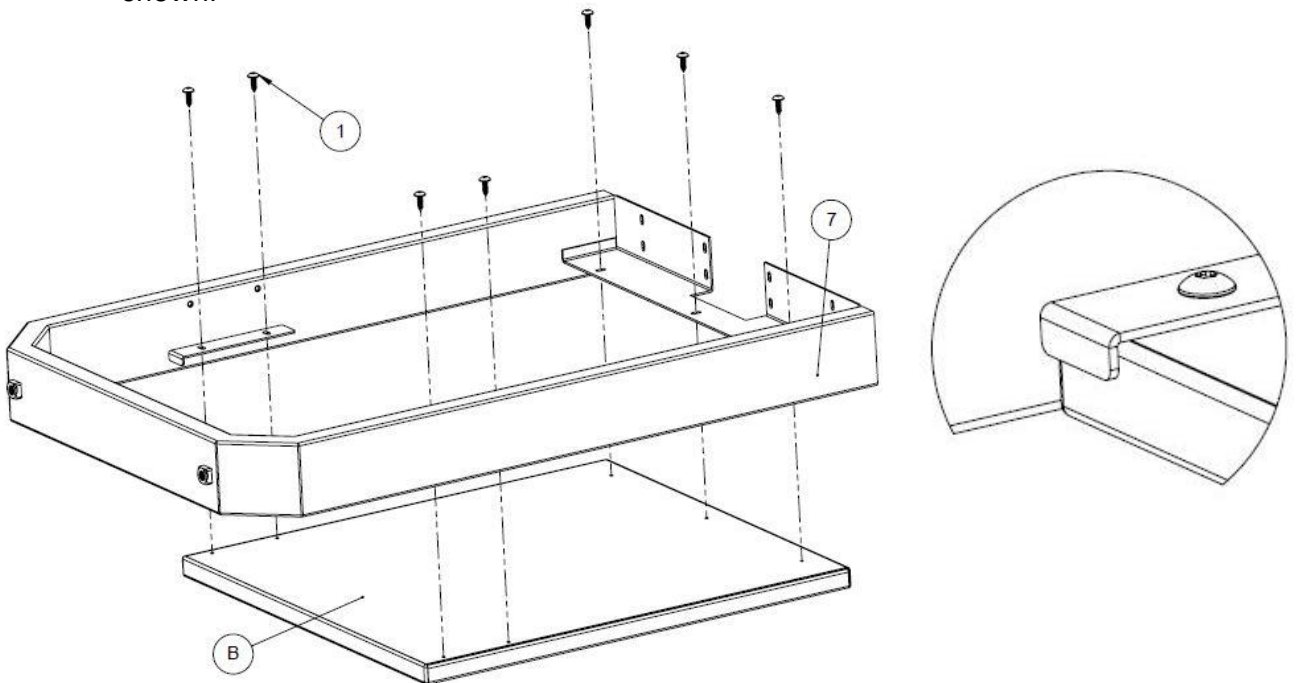

Assembly Instructions

3. Place wood top on clean smooth surface upside down with the pilot holes and reference lines facing up. The reference lines will be used to help align the metal components in future steps, these are only guides final locations will vary by assembly accuracy. (Panel H is used in these instruction, substitute panel H with panel E for 60" models)

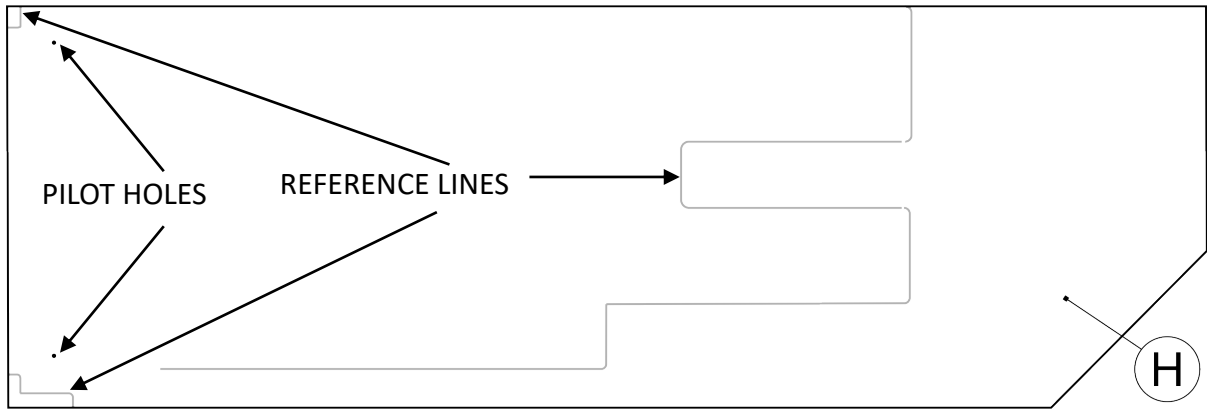

4. THE POSITION OF COMPONENT 3 IS CRITICAL, IT DETERMINES ALL OTHER COMPONENTS POSITIONS AND IS THE MOST DIFFICULT TO CHANGE AFTER THE ASSEMBLY IS DONE. The outside edge of item #3 vertical tubes should sit flush with the 3 indicated reference lines below.

5. Fasten item #3 down with 2x fasteners item #1 using the two pilot holes, confirm the location is correct as described above and install the remaining 6x fasteners item #1.

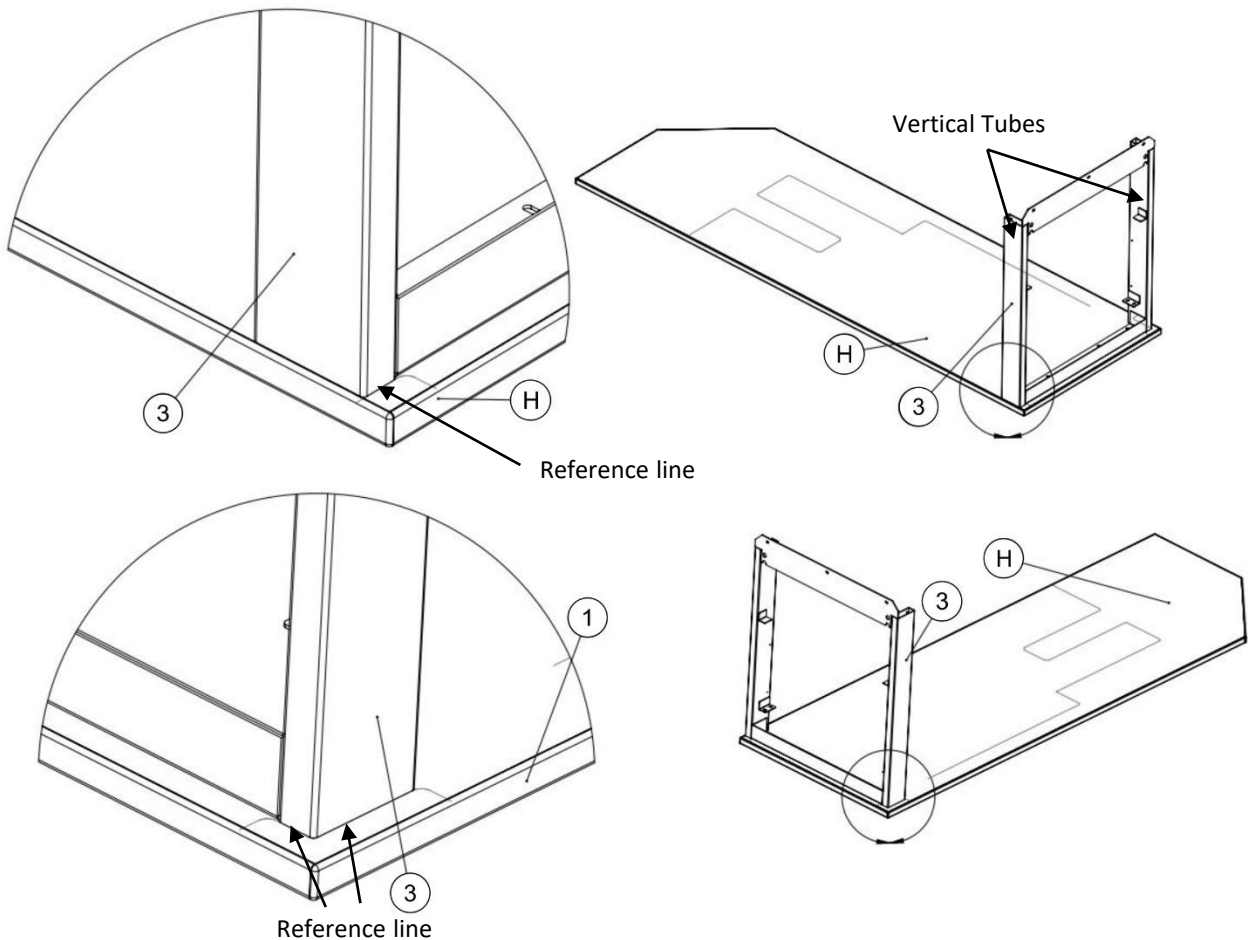

Assembly Instructions

5. Slide the previously assembled panel A onto item #3, item #7 should slide over the metal lip of item #3 as shown. Do not install any fasteners at this point this board will be removed later. It is helpful to clamp panel A to item #3.

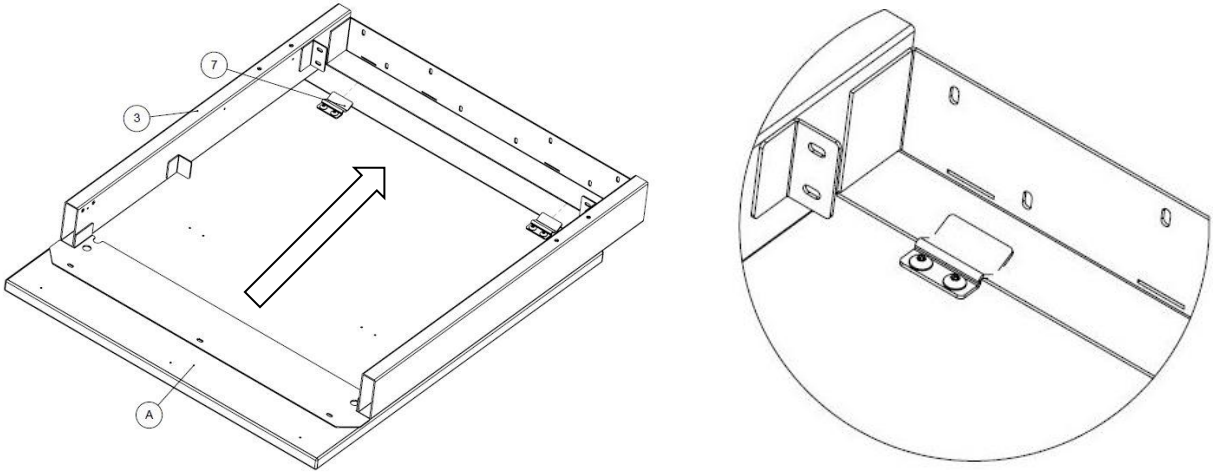

6. Install items #5 and #4 to item #3 as shown using 4x fastener item #3, finger tighten only.

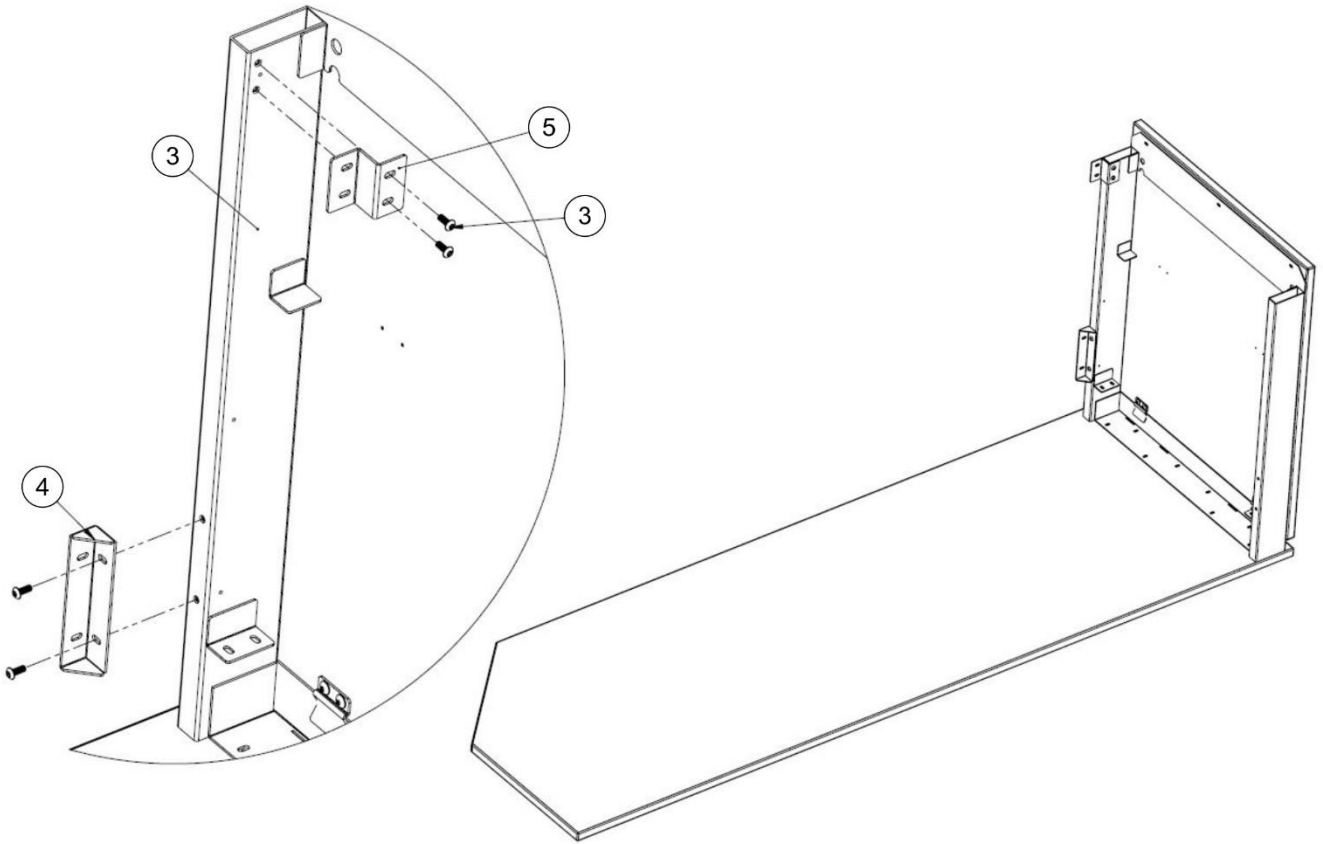

Assembly Instructions

7. Align item #12's edge with the reference line as shown. Item #12 should be touching Item #3 and the faces indicated below should be flush. Fasten #12 to top using 4x fastener #1.

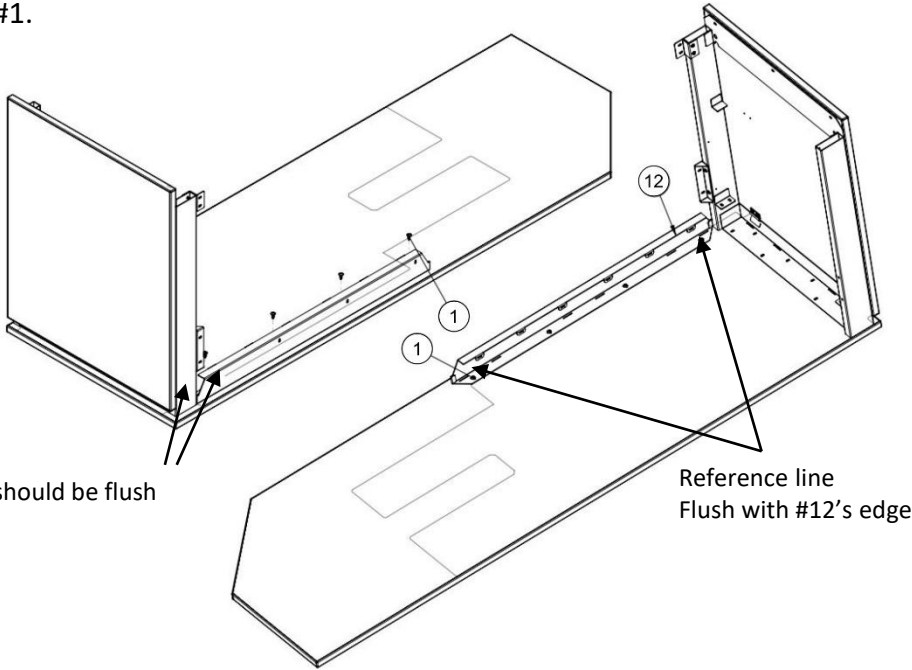

These faces should be flush

Reference line
Flush with #12's edge

8. Using 2x item #10 as spacers. Place panel D as shown. Confirm panel D and A edges align as show. Fasten panel D with the 2x indicated fastener #1 first, confirm panel D and A edges are still aligned and install the remaining 6x #1 fasteners

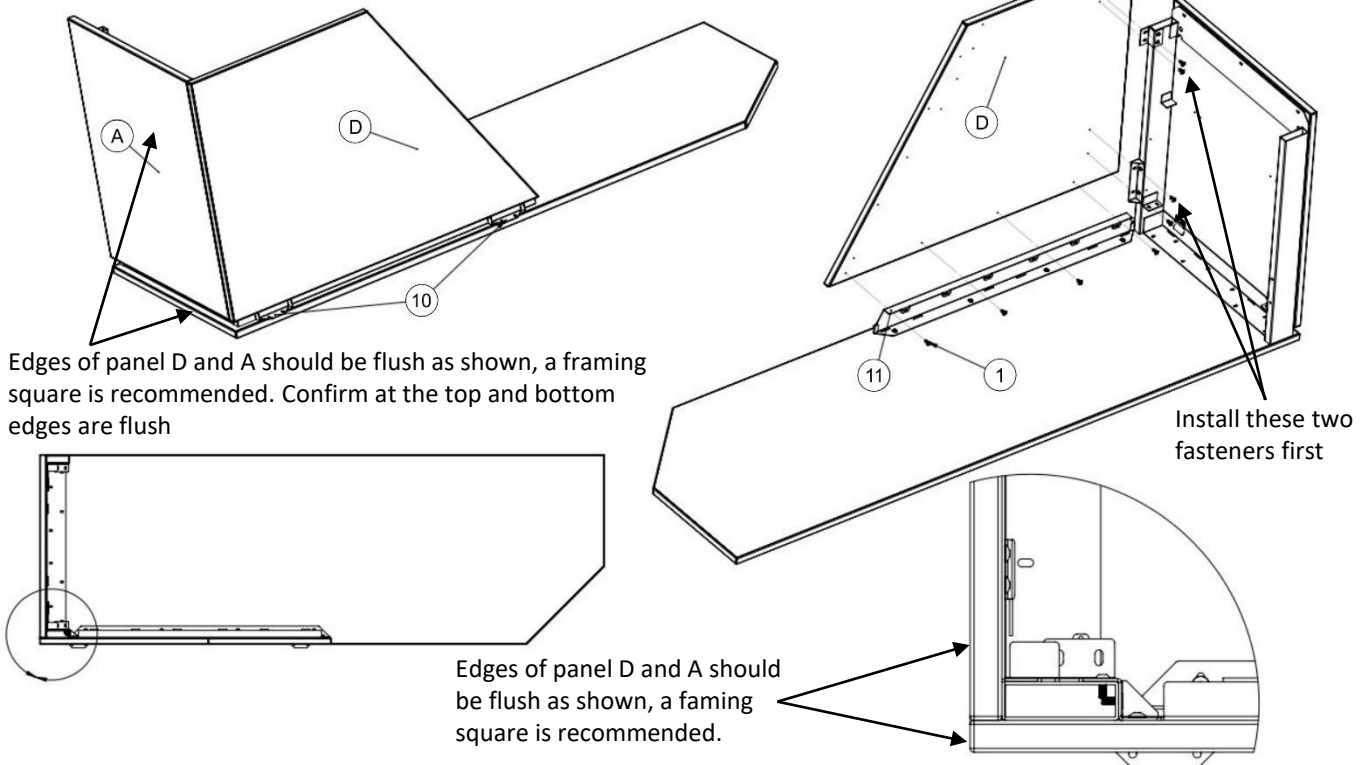

Edges of panel D and A should be flush as shown, a framing square is recommended. Confirm at the top and bottom edges are flush

Install these two fasteners first

Edges of panel D and A should be flush as shown, a faming square is recommended.

Assembly Instructions

9. Align item #10's edge with the reference line as shown. Item #10 should be touching Item #11. Fasten #10 to top using 2x fastener #1.

These faces of item #10 and #11 should touch

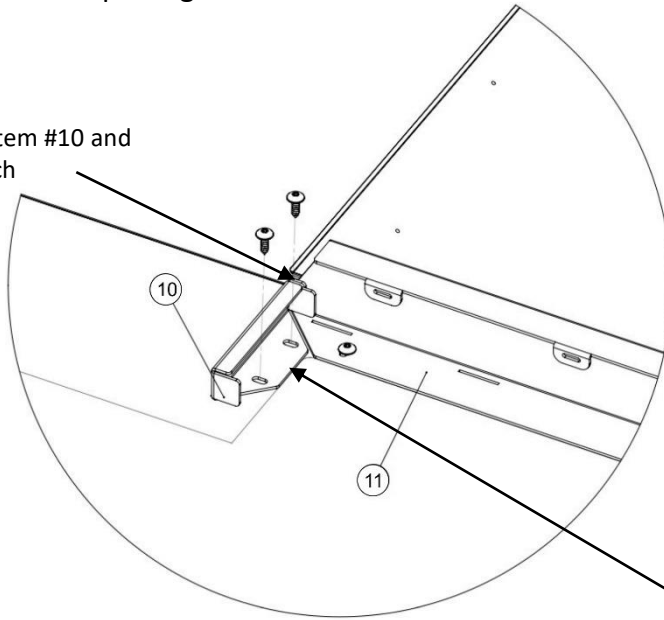

Reference line
Flush with #10's edge

10. Place item #12 as shown. Confirm panel D and item #12 faces align as show. Fasten item #12 with the 5x fasteners #1.

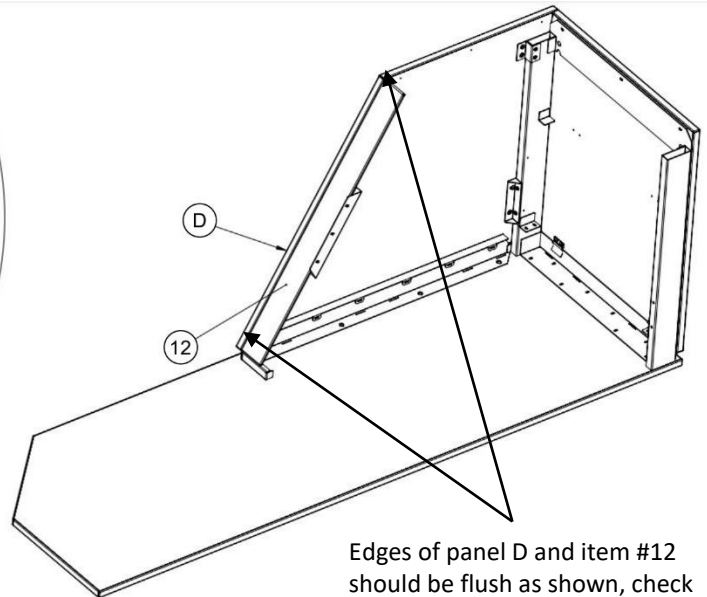
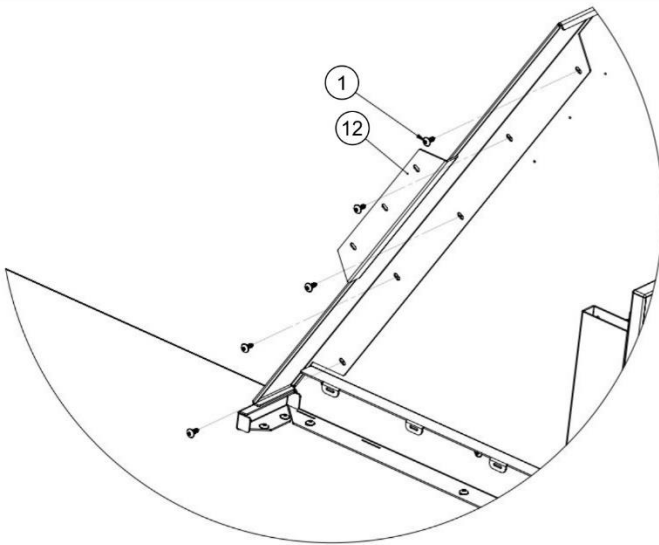

Edges of panel D and item #12 should be flush as shown, check top and bottom before fastening, a straight edge is recommended.

Assembly Instructions

11. Align item #9's edge with the reference line as shown. Item #10 can be used as a spacer for panel C. Insert panel C into the slot of Item #12. Place item #9 against panel C as show. Confirm that all 3x holes on item #12 and item #9 can be seen through the slots while item #10 is in place. Fasten #12 and #9 to panel C using 3x fastener #1 each. (Do not fasten item #9 to the panel H, this will be done in further steps)

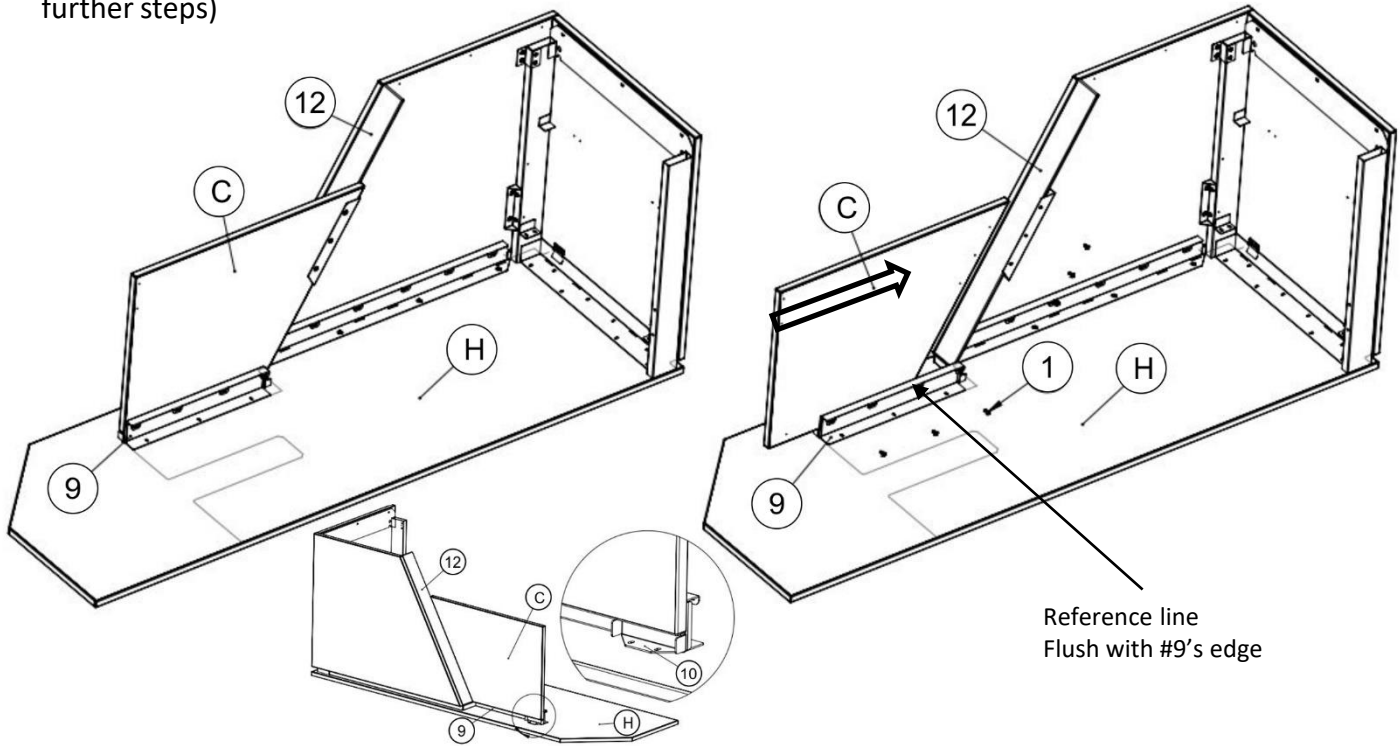

12. Place the previously assembled item #1 and panel B as shown. Attach item #8 using 2x fastener #1 to panel C and attached item #8 to item #1 using 2x fastener #3, finger tighten only. Confirm the gap between item #1 and panel C is constant and as minimal as possible as shown below. Fully tighten fasteners.

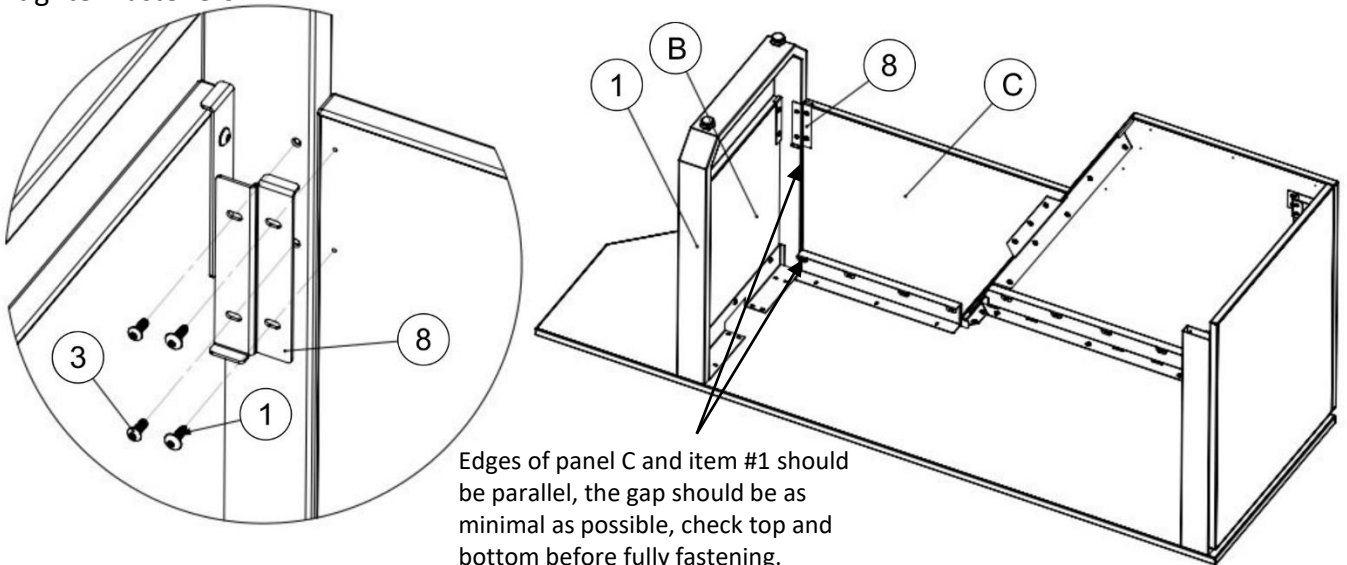

Assembly Instructions

13. Edge of item #1 should be parallel with the reference line as shown (depending on the assembly process the reference line may not be flush with the edge of item #1) Align edge of tube from item #1 with the edge of the wood, NOT the face of the edge banding. Fasten #1 to panel H using 8x fastener #1 and then fasten item #9 to panel H using 3x fastener #1.

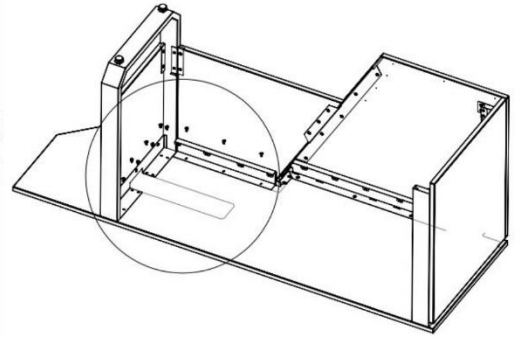
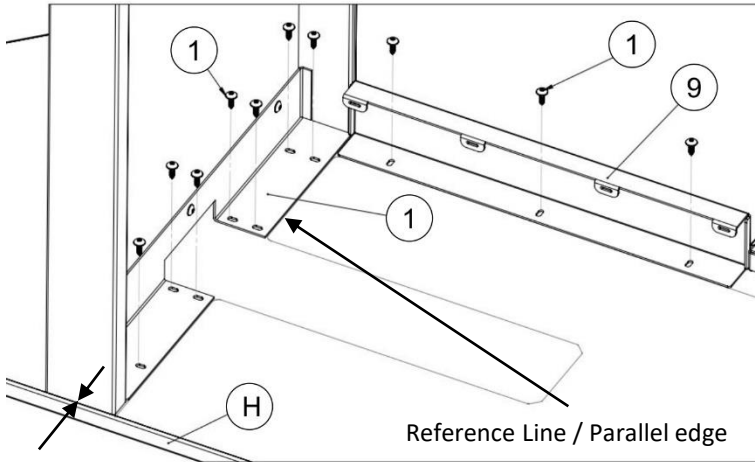

Align edge of tube from item #1 with the edge of the wood(brown surface), NOT the face of the edge banding.

14-A. This step is for 58001 and 58005 only, all other models skip to step 14-B.

Remove all components from inside 19179 before inverting. Remove panel A assembly and set to the side. Position 19179 the metal flanges should touch the metal components as shown below, install 8x fastener #1 on the two side flanges as shown.

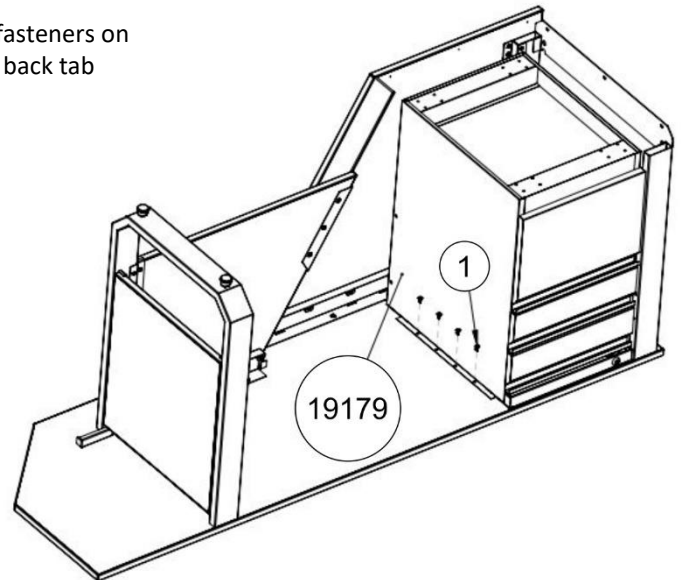
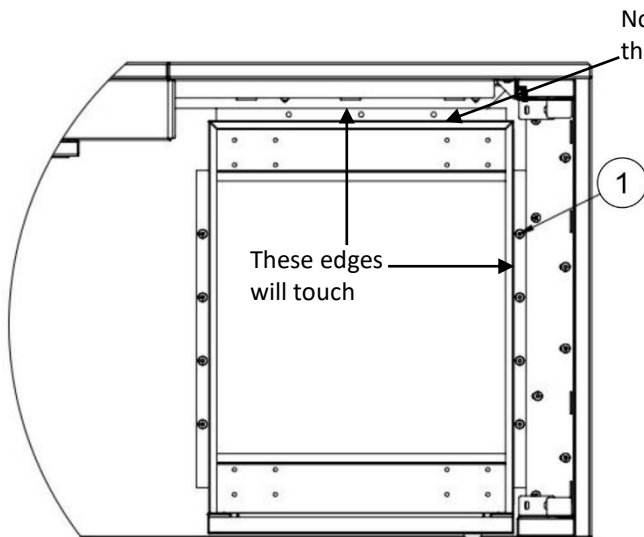

Assembly Instructions

14-B. This step is for 58003 and 58007 only.

Remove all components from inside 19178 before inverting. Remove panel A assembly and set to the side. Position 19178 front face is flush with the edge of wood as shown below, allow for a small gap between the tube of item #3 and hinge. (door is shown removed for illustrative purposes), install 6x fastener #1 in the 6x holes of 19178 as shown.

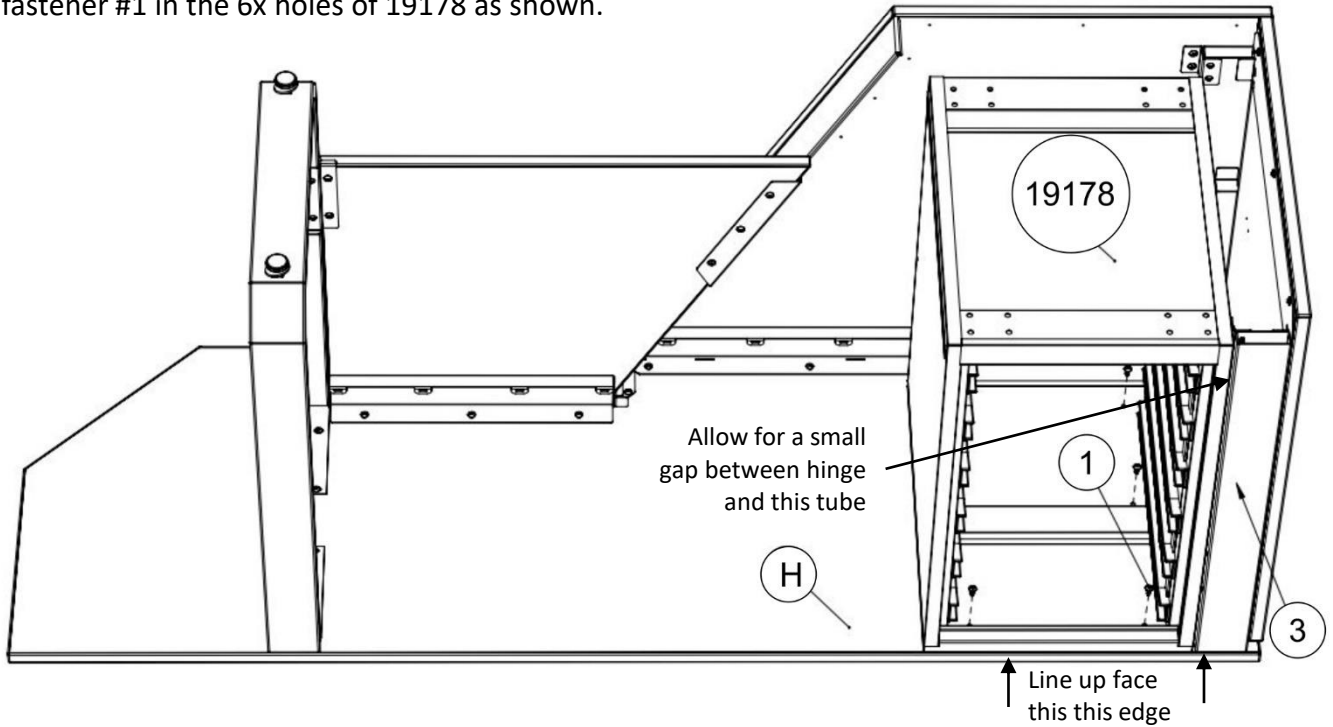

15. Place item #6 as shown, Fasten #6 to the tube of item #3 using 2x fastener #3, finger tighten only. Install 2x fastener #2. (Fastener #2 is a self drilling fastener, it will create 2 new holes in item 19179) Confirm there is a constant gap between 19179/19178 and the tube of item #3. Tighten the 2x fastener #2.

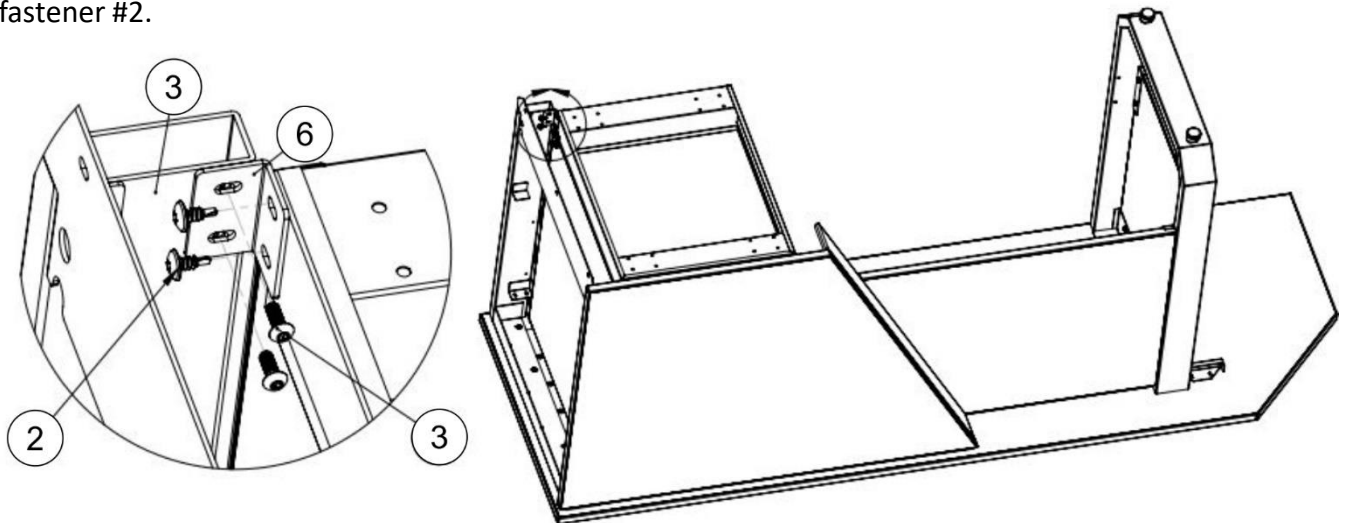

Assembly Instructions

16. Replace panel A, item #10 can be used as a spacer. Confirm that panel A and D are flush, a framing square is recommended. Install 3x fastener #1 into panel A

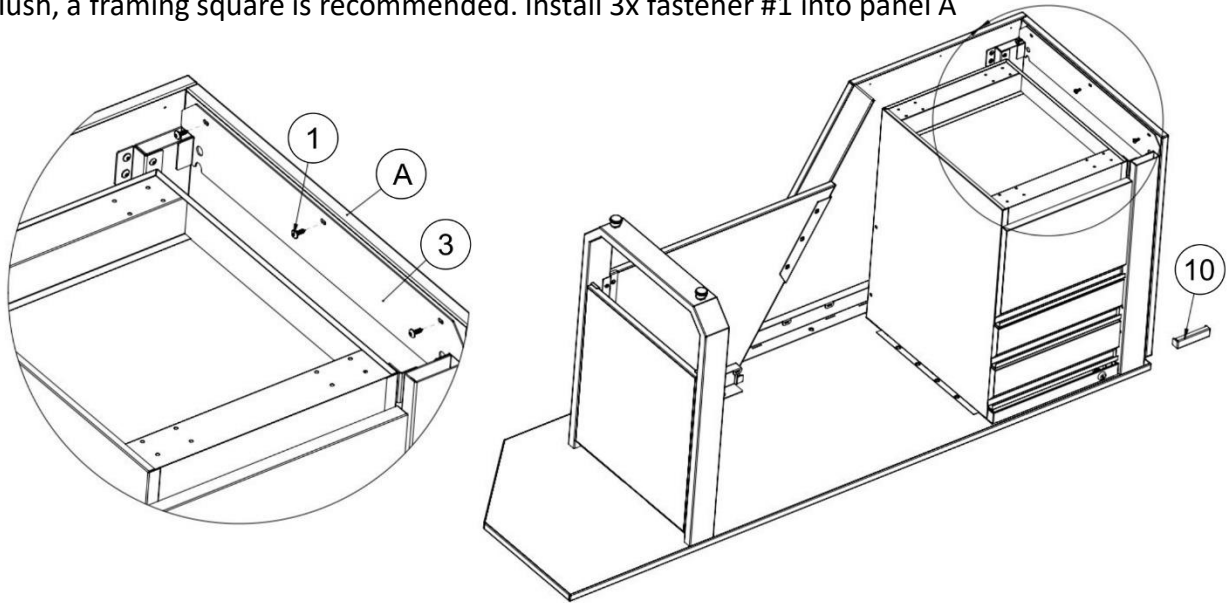

17. Place item #14 between the bottom of 19179/19178 and the casters that came with 19179/19178. Install the 16x fasteners that came with 19179/19178.

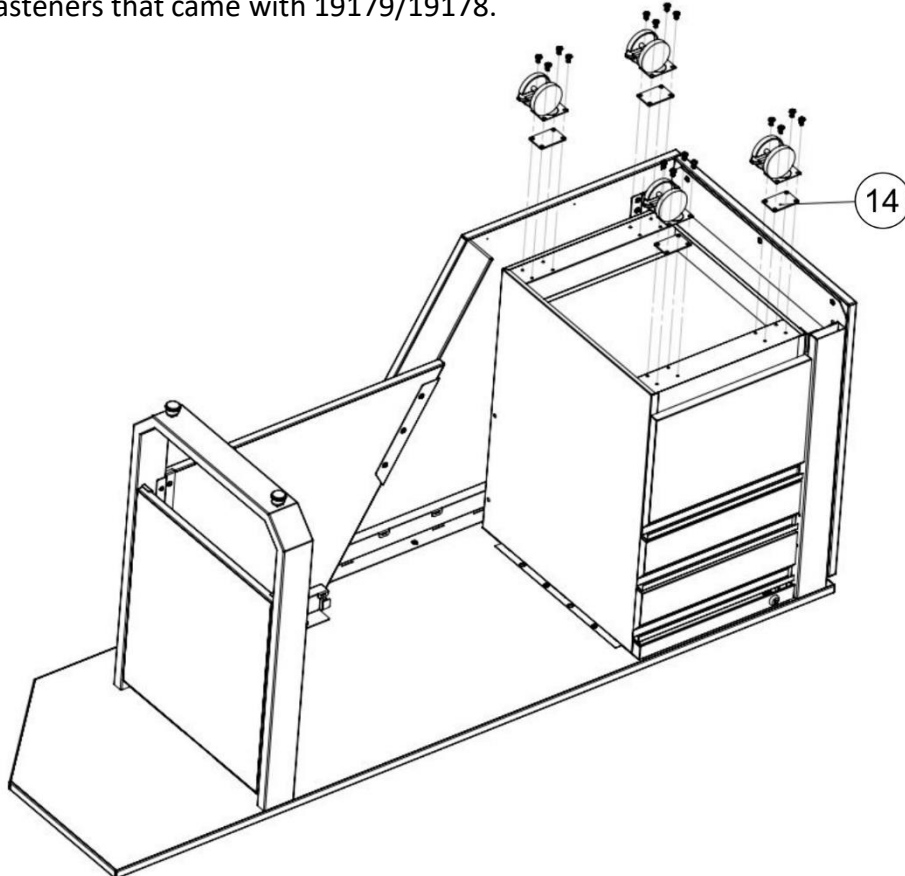

Assembly Instructions

18-A. This step is 72" Models only (58005 and 58007), for all other models skip to step 18-B. Line up item #15 with the reference line. Install 8x fasteners from hardware pack supplied with item #15 into panel H.

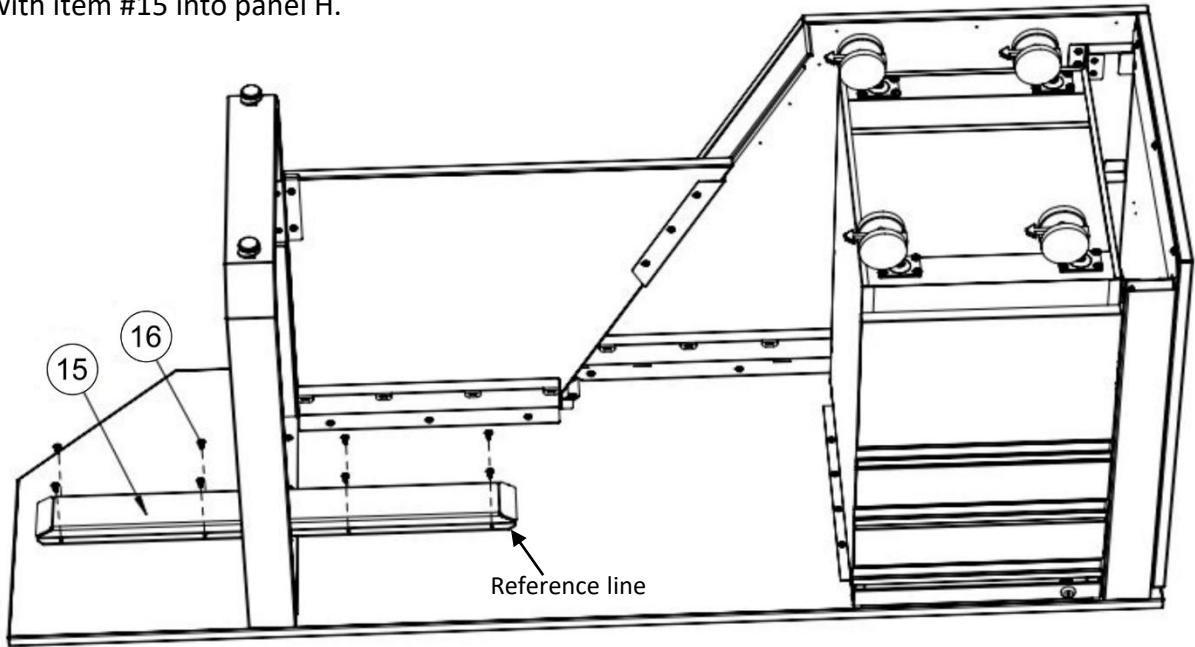

18-B. This step is for 60" Models only (58001 and 58003).

The indicated face of item #10 should be flush with item #1 as shown. Install 2x fasteners #1 into panel E.

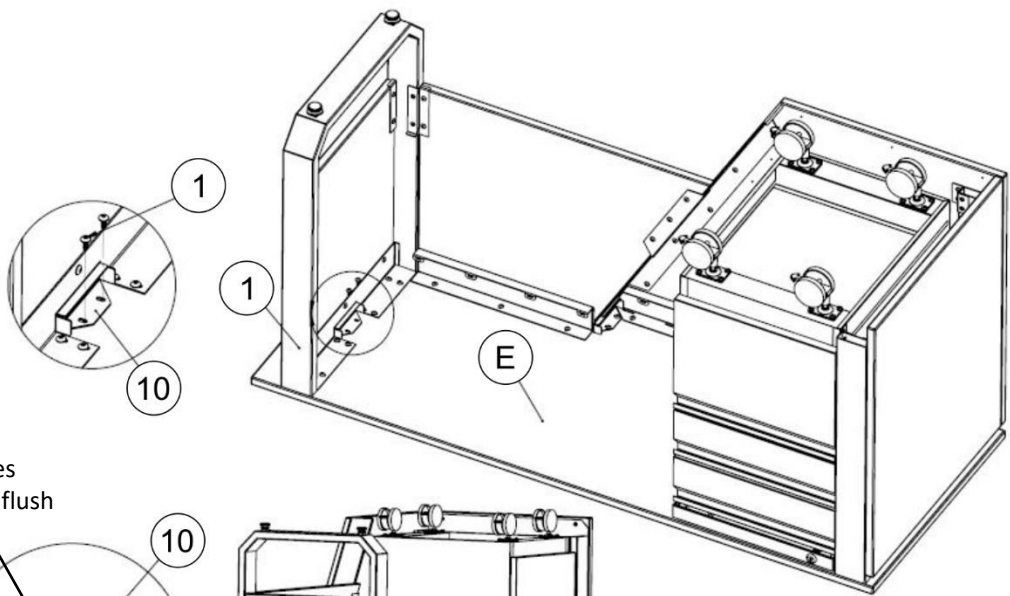

These faces should be flush

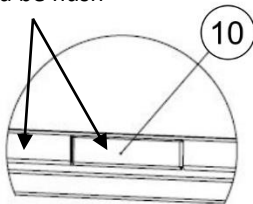

Assembly Instructions

19. Unlock all casters, on a soft, clean surface flip the desk on its front face as shown.

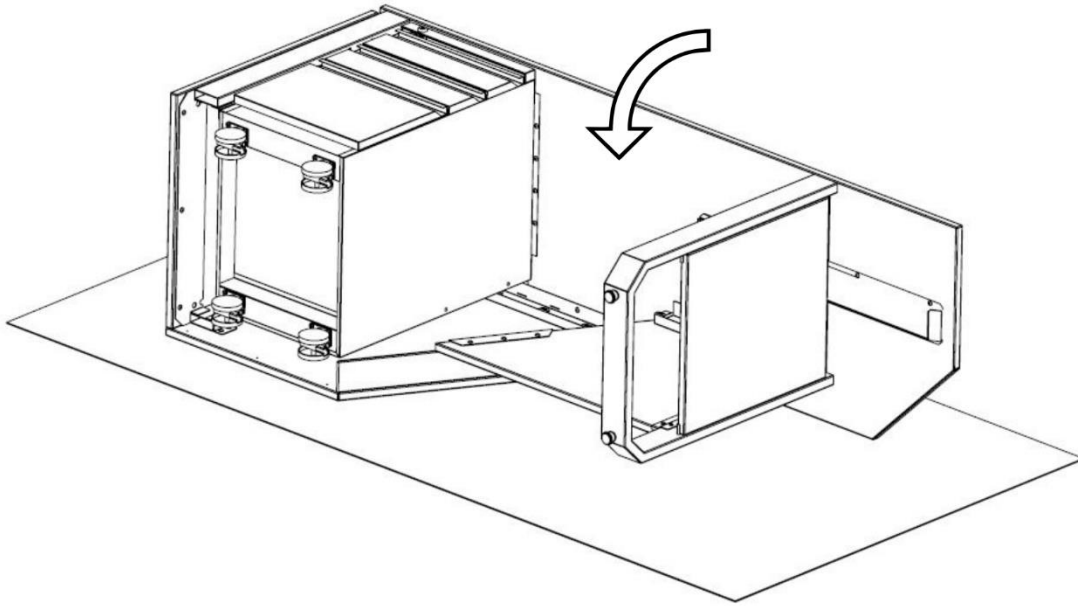

20. Flip desk onto casters as shown.

