



OVERVIEW

The Planner demonstration mirror comes in two sizes to fit tables that are 48" or 60" wide. The mirror allows every student to clearly view demonstrations, allowing instruction without the need of a projector. The adjustable height and 360° rotation allows the mirror to operate from any location.

MATERIALS

The mirror is 1/8" thick acrylic plastic. The frame is made of 16 gauge steel tubing and steel brackets, 1/4" thick coined steel brackets, 1 1/8" diameter machined aluminum rod, and plastic corner bumpers. The mounting clamp includes a 15 degree steel and rubber leveling mount.

DIMENSIONS

Model	Description	D"	W"	H"	WT
MIRROR48	Planner Demonstration Mirror 48"	5.25	48.875	48.75-59.875	18.88
MIRROR60	Planner Demonstration Mirror 60"	5.25	60.875	48.75-59.875	19.42

MIRROR48

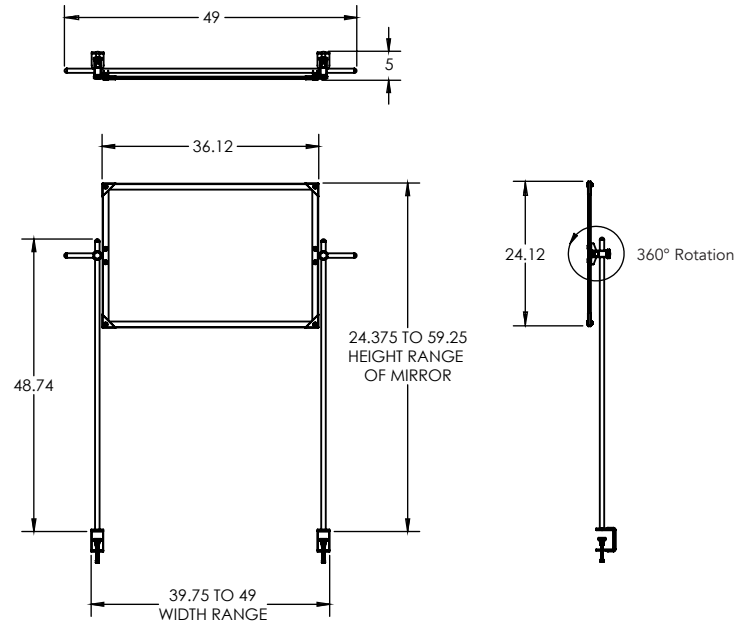

MIRROR60

